

METAL ONE PIECE SELF DRILLING ANCHOR

Fortress Pro-Pak Metal Plasterboard Screws are a one piece self drilling anchor designed for use in hollow plasterboard for light duty loads.

TECHNICAL DATA:

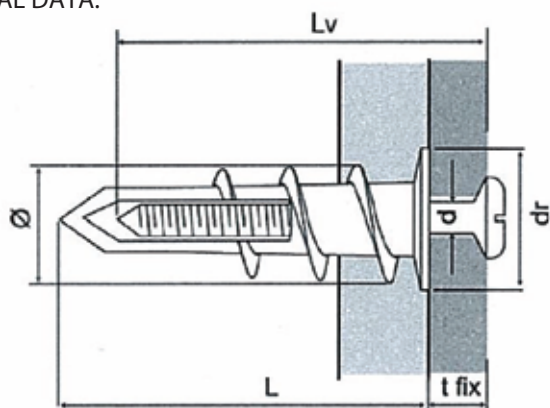

tfix = fixture thickness
hnom = nominal embedment depth
hmin = minimum support thickness
d = screw diameter
L = anchor length
dr = washer diameter
Lv = screw length
Ø = anchor diameter

Product Size do x L	tfix (mm)	hnom (mm)	hmin (mm)	Lv (mm)	d (mm)	dr (mm)
Ø13 x 30	10	30	60	35	4	14

BASE MATERIAL – PRO-PAK Metal Plaster Board Screw can be applied to the following base materials

✿ Plasterboard ✿ Aerated Concrete Panels

INSTALLATION GUIDE – Position anchor in the desired area, press firmly and wind until secure. Then apply self tapping screw through the centre of the anchor

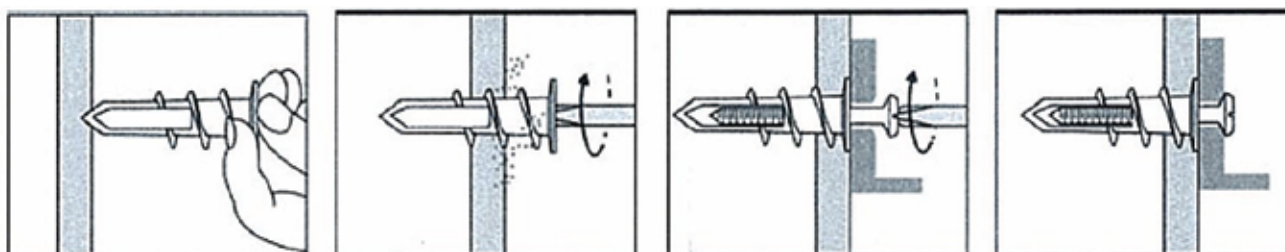

RECOMMENDED LOADS

Plasterboard (13mm)	Tensile	kN	0.05
	Shear	kN	0.10
Aerated Concrete	Tensile	kN	0.10
	Shear	kN	0.20
Edge Distance		mm	50
Plug Spacing		mm	50
Nominal Embedment Depth		mm	38